

WBS: BP14.R002

CONTRACT: DN00492

See Sheet 1A For Index of Sheets
See Sheet 1B For Conventional Symbols

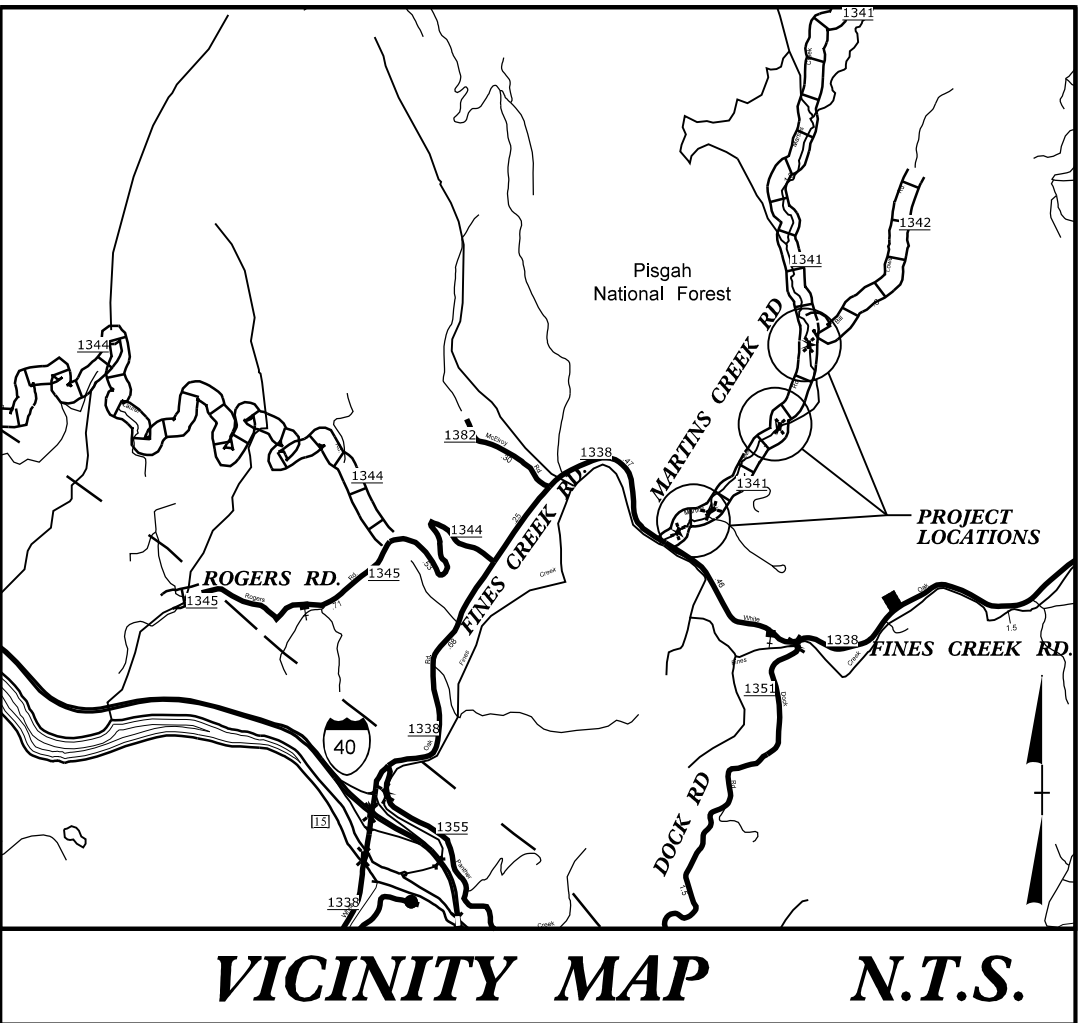

100% PLANS

STATE OF NORTH CAROLINA
DIVISION OF HIGHWAYS

HAYWOOD COUNTY

LOCATION: CULVERTS 430187, 430188, 430189 AND 430190 OVER
MARTINS CREEK ON SR 1341 (MARTINS CREEK RD)

TYPE OF WORK: GRADING, DRAINAGE, PAVING AND CULVERTS

STATE	STATE PROJECT REFERENCE NO.	SHEET NO.	TOTAL SHEETS
N.C.	BP14.R002	1	
STATE PROJ. NO.	F.A. PROJ. NO.	DESCRIPTION	
BP14.R002.1	N/A	PE	
BP14.R002.2	N/A	ROW, UTL.	
BP14.R002.3	N/A	CONST	

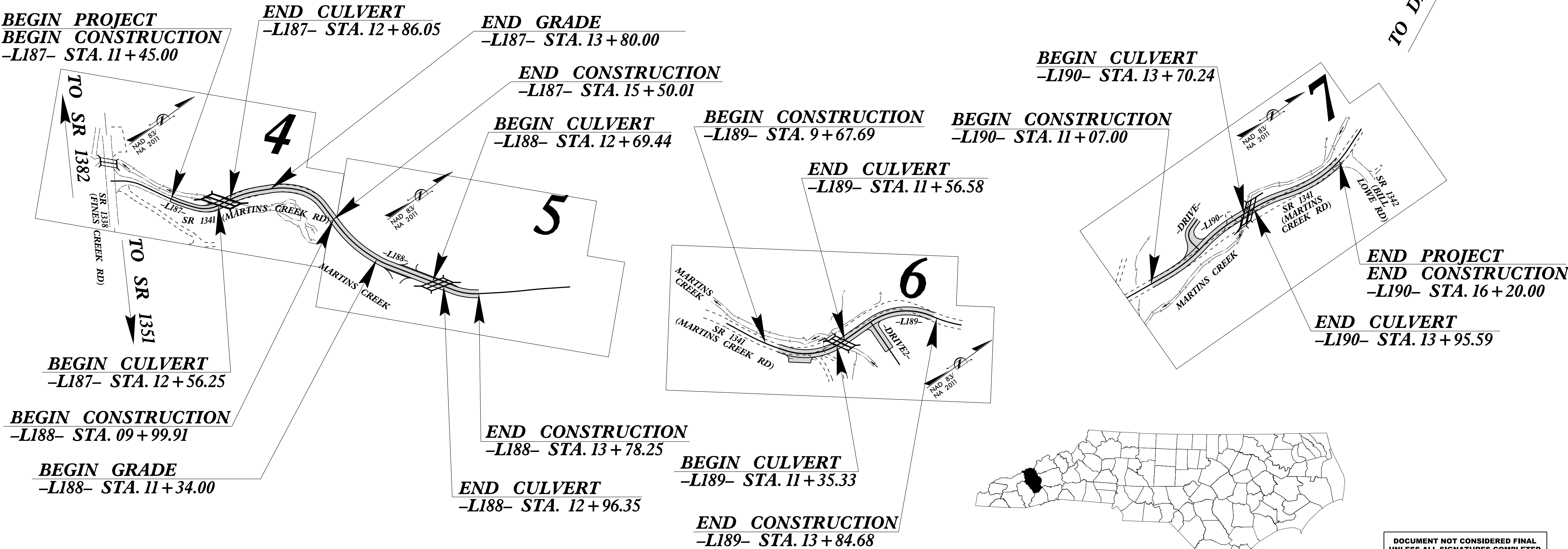

DOCUMENT NOT CONSIDERED FINAL
UNLESS ALL SIGNATURES COMPLETED

GRAPHIC SCALES

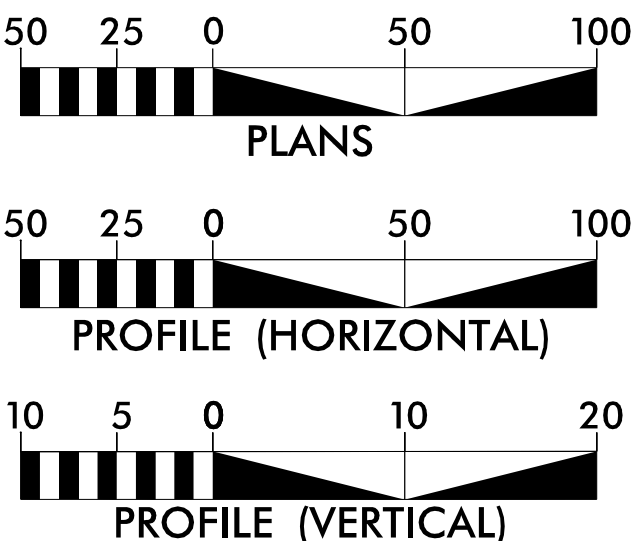

DESIGN DATA

ADT 2016 = 100

T = 6%
V = 25 MPH
430187, 430188, 430189
V = 30 MPH
430190

FUNC CLASS =
LOCAL
SUB REGIONAL TIER

PROJECT LENGTH

LENGTH ROADWAY = 0.305 MILES
LENGTH STRUCTURE = 0.020 MILES
TOTAL LENGTH = 0.325 MILES

-L187-, -L188-, -L189- & -L190- USED TO CALCULATE LENGTH

Prepared in the Office of:
RS&H
ARCHITECTS-ENGINEERS-PLANNERS, INC.
8521 SIX FORKS RD, SUITE 400
RALEIGH, NC 27615

2024 STANDARD SPECIFICATIONS

RIGHT OF WAY DATE:
MARCH 2024

LETTING DATE:
JANUARY 27, 2026

SEAN KORTOVICH, PE
PROJECT ENGINEER

ALLISON HARRIS, PE
PROJECT DESIGN ENGINEER

ZACH SHULER, PE
NCDOT CONTACT

HYDRAULICS
ENGINEER



DocuSigned by:
Alexander R Vinson
12/1/2025
P.E.



Signed by:
Sean M. Kortovich
11/24/2025
P.E.

ROADWAY DESIGN
ENGINEER

